

PRODUCT DATA SHEET

DELTA AT800

Product Code: DMS026



info@deltamembranes.com

www.deltamembranes.com

01992 523 523

Delta AT 800 is an innovative Type C Drainage Membrane which conforms to BS 8102:2009 and BS 8485:2015+A1:2019, Table 7 achieving waterproofing and ground gas protection simultaneously.

Delta AT 800 offers maximum protection in just one application. Designed to offer drainage protection in Type C waterproofing (Grade 3 environment) in accordance with BS 8102:2009 this innovative membrane also offers barrier protection to ground gases Carbon Dioxide, Radon and Methane in accordance with BS 8485:2015 +A1:2019, Table 7 with high adhesion to the application of flame retardants.

PRODUCT DATA SHEET

DELTA AT 800

Product Code: DMS026

Delta AT 800 offers maximum protection in just one application. Designed to offer drainage protection in Type C waterproofing (Grade 3 environment) in accordance with BS 8102:2009 this innovative membrane also offers barrier protection to ground gases Carbon Dioxide, Radon and Methane in accordance with BS 8485:2015 +A1:2019, Table 7 with high adhesion to the application of flame retardants.

This Virgin Polymer profiled membrane with superior drainage capacity and compressive strength has been used in the construction of the Gothard tunnel and several stations of the Moscow Metro.

| CHARACTERISTICS | METHODS | VALUES | UNITS |
|-------------------------------------|------------------------------------|--------------------|---------------------------------|
| Dimpled Sheet | - | Virgin Polymer | - |
| Geotextile | - | None | - |
| Additional Layer(s) | - | None | - |
| Flat Edge/Self-adhesive Edge | - | Yes/None | - |
| Dimpled Height | EN 964 | Approx 9 | mm |
| Air Gap Between Dimples | - | Approx 7. 9 | l/m ² |
| Contact Area Dimples/ Surface | - | Approx 700 | cm ² /m ² |
| Diagonal Dimples per m ² | - | Approx 2,500 | Pcs |
| Dimensions of rolls | EN 1848-2 | 20 x 2. 0 | m |
| Straightness | EN 1848-2 | Passed <75 | l/m ² |
| Package | - | 6 Rolls on Pallets | - |
| Certification | Specification sheet Alp Transit | Passed | - |

Head Office:

Delta House, Merlin Way, North Weald, Epping, Essex, CM16 6HR
01992 523 523 | info@deltamembranes.com | www.deltamembranes.com

DMSPDS2020

PRODUCT DATA SHEET

DELTA AT 800

Product Code: DMS026

| CHARACTERISTICS | METHODS | VALUES | UNITS |
|-----------------|---------|--------|-------|
|-----------------|---------|--------|-------|

Mechanical Properties

| | | | |
|---|----------------|----------------------------|-----|
| Pressure Resistance | EN ISO 25619-2 | Approx 650 | kPA |
| Resistance against mechanical perforation | EN 918 | Diameter of the hole: 13.4 | mm |

Other Properties

| | | | |
|---|----------------|-----------------|----------------------------|
| Service temp range | - | -30 up to +80 | °C |
| Resistance to water Penetration | EN 1928 | Waterproof | - |
| Resistance of waterproofness against artificial aging at elevated temps | EN 1296 | Passed | - |
| Durability under alkaline environment | EN 13984 | Passed | - |
| Methane Permeability | EN ISO 15105-1 | <31 (less than) | ml/m ² /day/atm |

Drainage Capacity in the plane

| Drainage Capacity in the plane | | | EN ISO 12958 | | |
|--------------------------------|--------------------|--------|--------------|----------|----------|
| Load | Hydraulic gradient | i=0.02 | i = 0.03 | i = 0.10 | i = 1.00 |
| 20 kPA | | 0.33 | 0.42 | 0.84 | 3.10 |
| 200 kPA | | 0.33 | 0.42 | 0.84 | 3.10 |
| | | | | | l/s m |

Head Office:

Delta House, Merlin Way, North Weald, Epping, Essex, CM16 6HR
 01992 523 523 | info@deltamembranes.com | www.deltamembranes.com

DMSPDS2020



BENEFITS

- Rapid cost effective installation
- Compatible with all types of construction
- Ideal for complex substructures
- Guaranteed performance
- Suitable for new and existing buildings
- Suitable for high volumes of water penetration
- Suitable for ground gas protection
- A reversible system, which will minimize damage to historical or heritage structures
- An effective barrier to the transmission of salts, liquid water and water vapour
- An effective barrier to gas – including Methane, CO₂ and Radon
- Durable for 100 years in natural soil with $4 \leq \text{pH} \leq 9$ and soil temperature $\leq 25^\circ\text{C}$



SPECIFICATION

- BS 8102:2009, Code of practice for protection of below ground structures against water from the ground
- Table 7, BS 8485:2015 +A1:2019 Code of practice for the design of protective measures for methane and carbon dioxide ground gases for new buildings

PRODUCT DATA SHEET

DELTA AT 800

Product Code: DMS026

TECHNICAL DRAWING

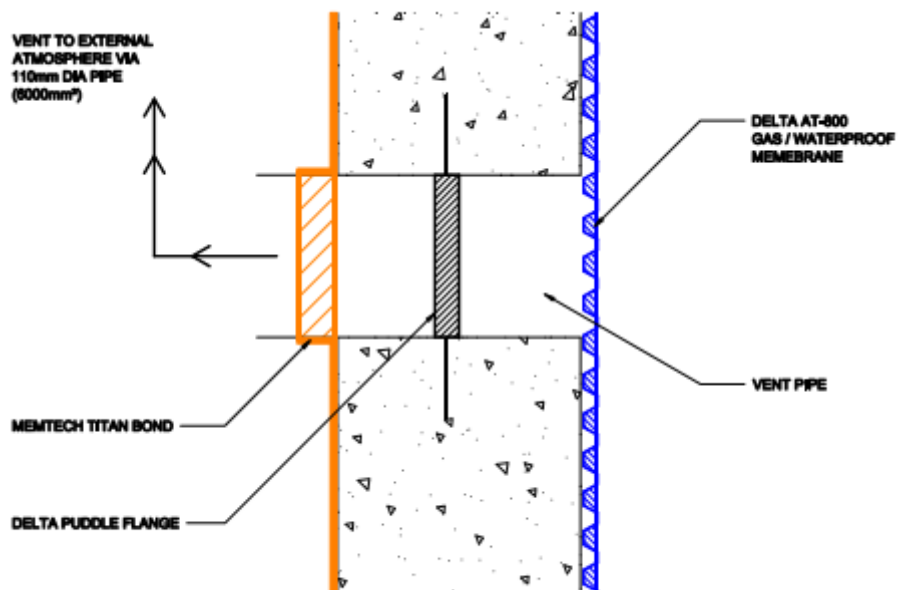
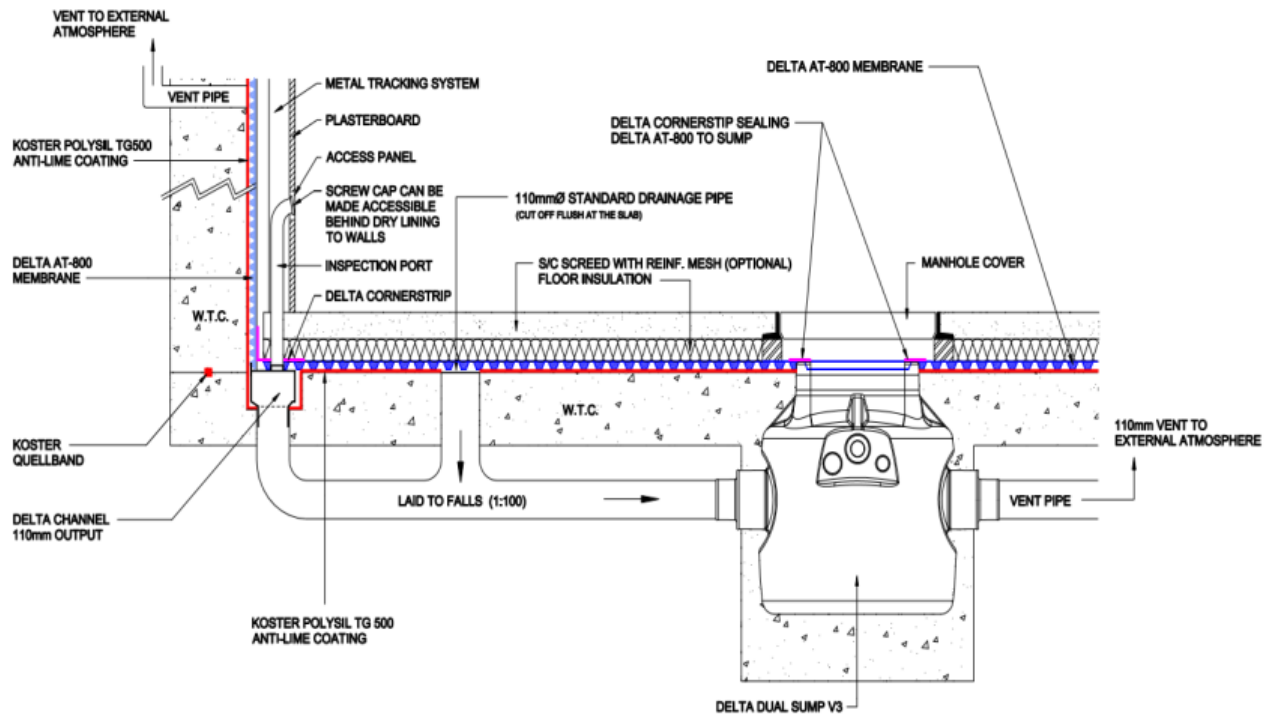

Head Office:
 Delta House, Merlin Way, North Weald, Epping, Essex, CM16 6HR
 01992 523 523 | info@deltamembranes.com | www.deltamembranes.com

DMS026